



basic education

Department:
Basic Education
REPUBLIC OF SOUTH AFRICA

SENIOR CERTIFICATE EXAMINATIONS/ NATIONAL SENIOR CERTIFICATE EXAMINATIONS

MATHEMATICAL LITERACY P2





ADDENDUM

MAY/JUNE 2024

This addendum consists of 7 pages with 6 annexures.

ANNEXURE A
QUESTION 2.1

SITE MAP OF THE BLOEM AGRICULTURAL SHOW AND THE
ENTRANCE GATES TO THE SHOWGROUNDS

KEY	
P	Police
+	First aid
	Public parking area
	Horses
	Sheep, goats and pigs (Small livestock)
	Cattle
E	Main entertainment area
	The position and number of the gates

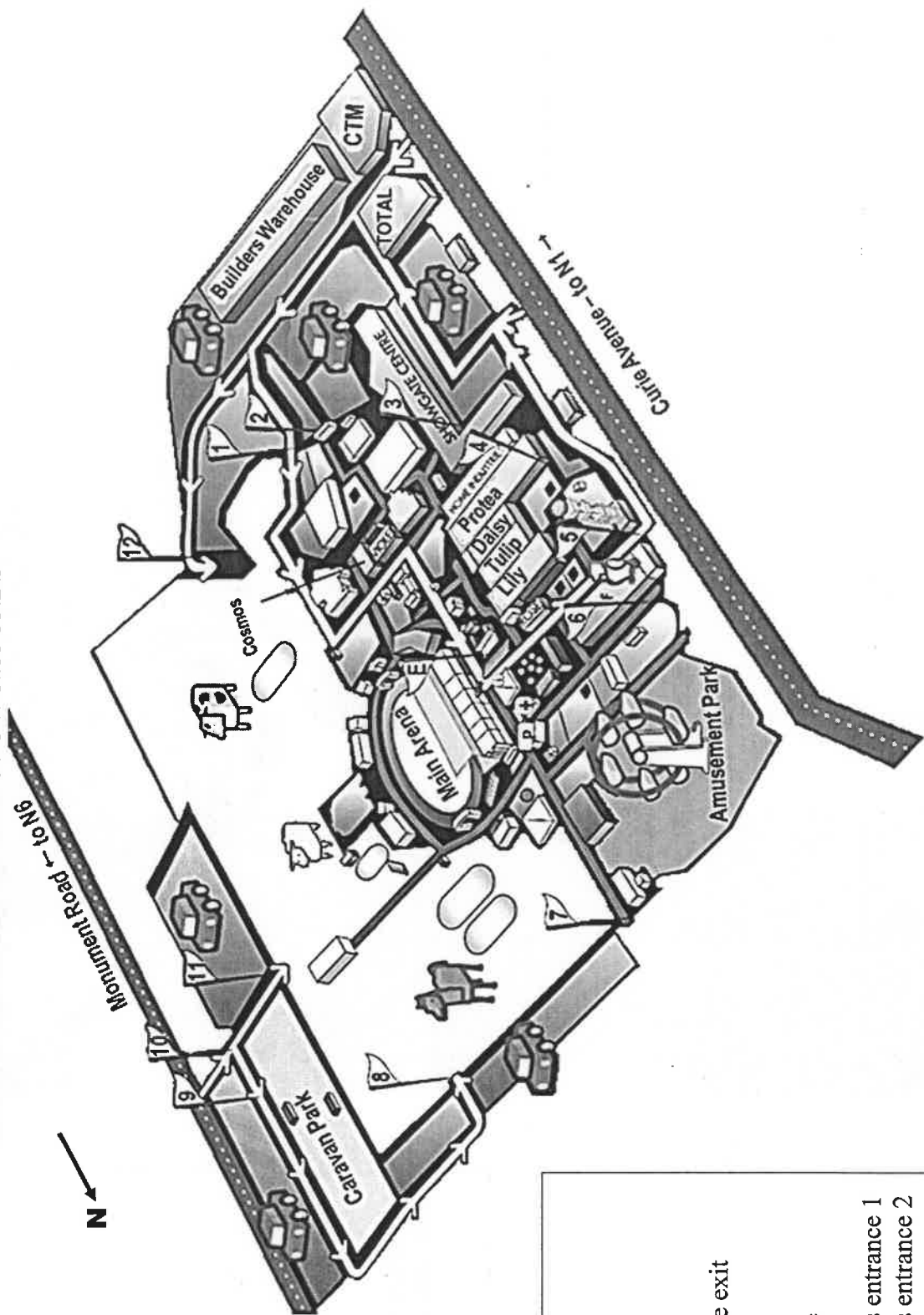

GATES

- 1 Vehicle entrance
- 2 Main public entrance
- 3 Showgate public entrance
- 4 Devil's Fork Factory public entrance
- 5 Vodacom public entrance and vehicle exit
- 6 Police gate (no entrance)
- 7 Railway public entrance
- 8 Horses vehicle and breeders entrance
- 9 Caravan park and vehicle entrance
- 10 Small livestock vehicle and breeders entrance 1
- 11 Small livestock vehicle and breeders entrance 2
- 12 Cattle vehicle and breeders entrance

ANNEXURE B

QUESTION 2.2

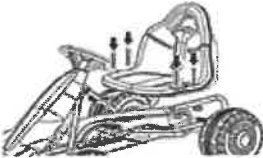
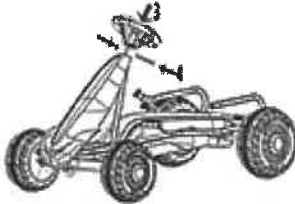
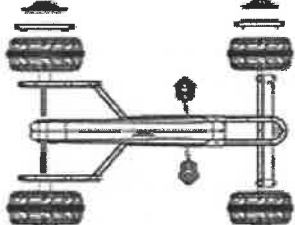
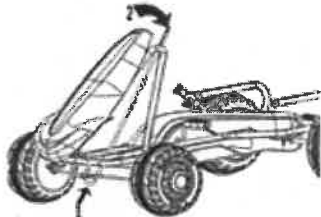
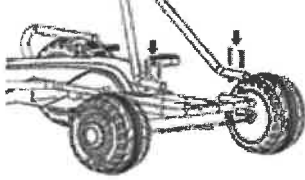
COLUMN A: INSTRUCTIONS	COLUMN B: PICTURES
<p>2.2.1 Assemble the wheel caps Fasten the hubs to the rims and then insert the decorative cover into the wheel cover.</p>	<p>A</p> 
<p>2.2.2 Attach the frame tubing to the pedal mechanism Attach the frame tubing to the pedal mechanism and secure.</p>	<p>B</p> 
<p>2.2.3 Assemble the steering mechanism Insert the steering rod through the hole at the bottom of the frame and into the central hole of the bracket.</p>	<p>C</p> 
<p>2.2.4 Assemble the front panel and steering wheel Insert the steering wheel into the steering rod. Then affix, tightening the locknut.</p>	<p>D</p> 
<p>2.2.5 Assemble the seat Fasten the seat on the body with four bolts, washers and nuts.</p>	<p>E</p> 

[Adapted from Kogan-Kids-Pedal-Go-Kart-KAPDGKRTBLA-Manual]

ANNEXURE C

QUESTION 3.2

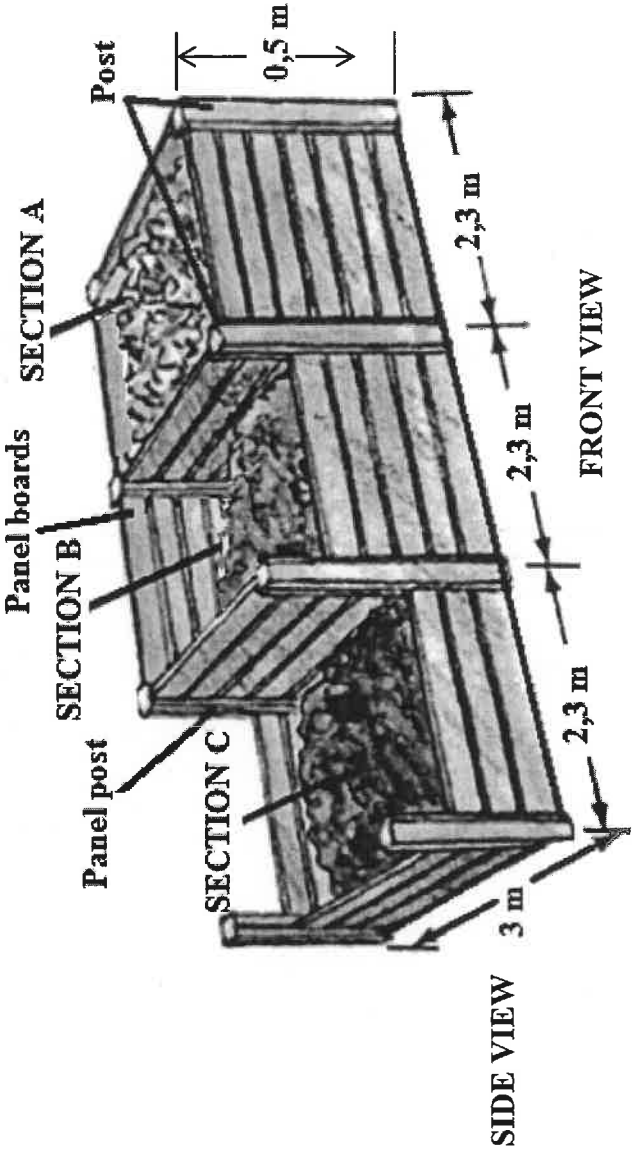
ONE OF THE FOUR EQUAL VIEWS OF SECTION A	RECTANGULAR-BASED COMPOST BOX SHOWING THREE LINKED SECTIONS (A, B and C) WITH PANEL BOARDS
	

ANNEXURE D

QUESTION 4.1

LAYOUT PLAN OF THE SCHOOL BUILDING

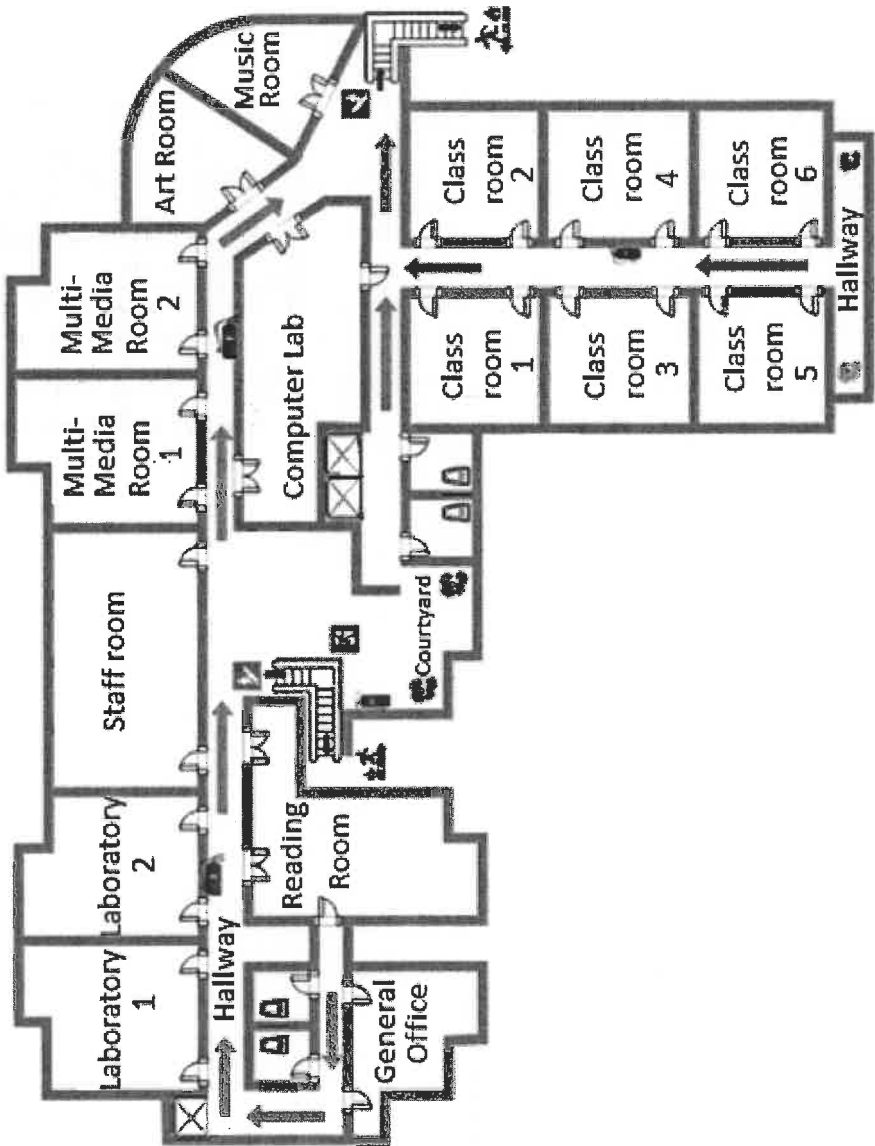

KEY	
EXPLANATION	SYMBOL
Door, single	
Door, double	
Exit to use in case of fire	
Stairs	
Fire extinguisher	
Hallway direction to follow in case of evacuation	

[Source: www.edrawsoft.com/template-school-layout.html]

ANNEXURE E

QUESTION 4.2

STRIP MAP OF ROADS CONNECTING ZAMBIA AND SOUTH AFRICA

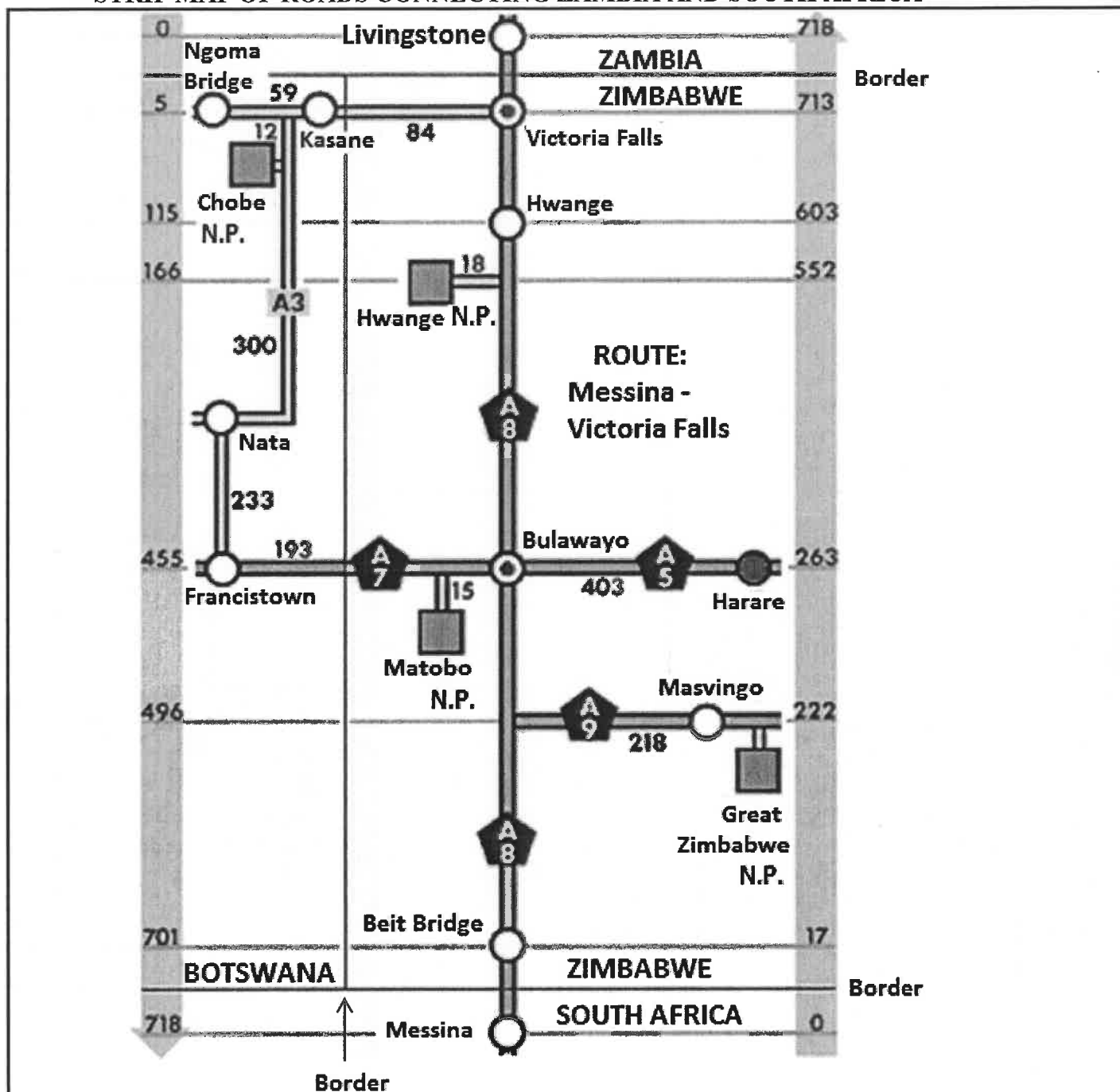

KEY:

National road	=		SOUTH AFRICA	=	Country
National road (Botswana)	=		Harare	=	Town/City
National park (N.P.)	=				

ANNEXURE F
QUESTION 5.1

LAYOUT PLAN OF THE GROUND FLOOR OF THE FOUR-STOREY BUILDING SHOWING TWO APARTMENTS

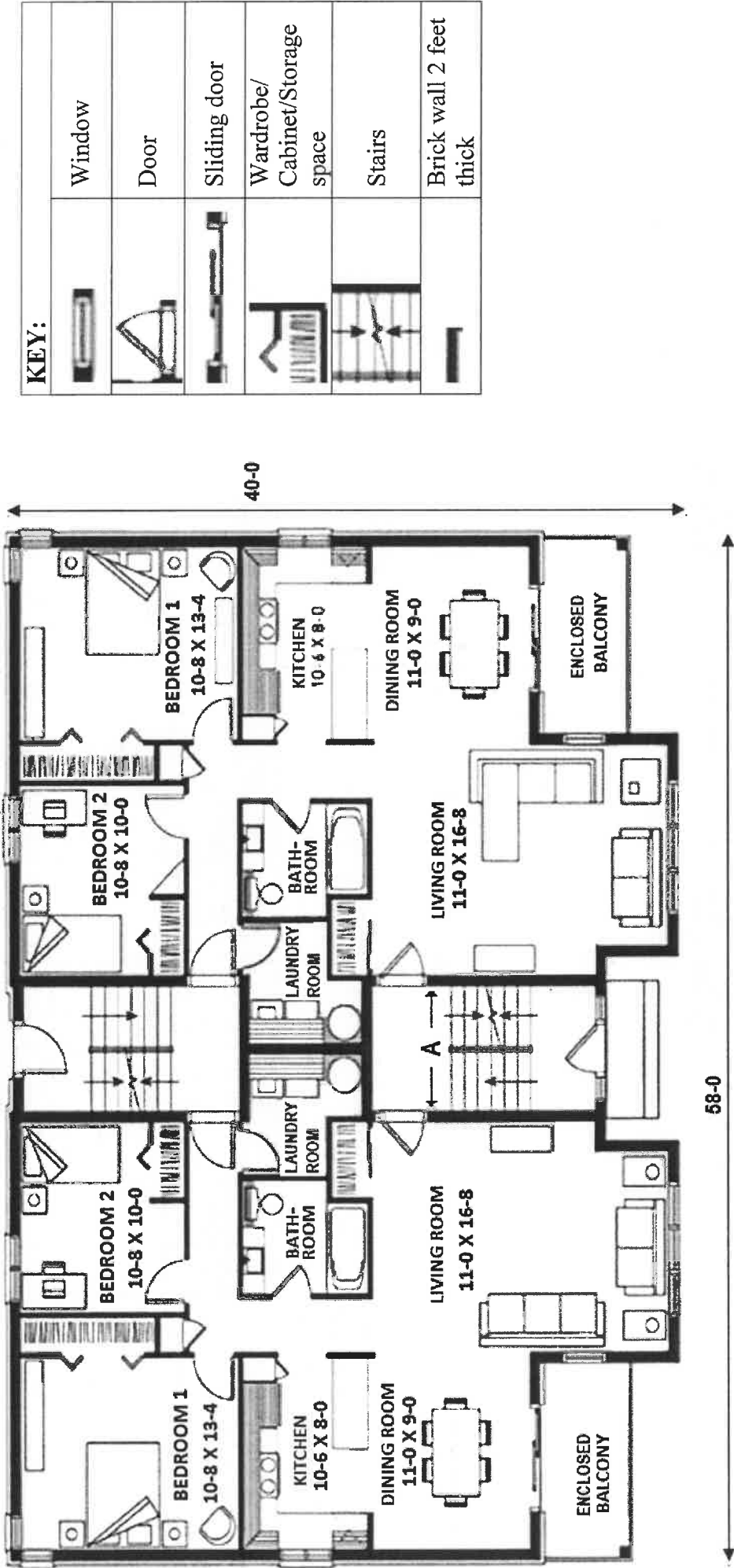

NOTE: 58-0 means 58 feet
10-8 means 10 feet and 8 inches
All dimensions inside the building are given as length × width.